

|   |   |   |
|---|---|---|
| 1 | 2 | 3 |
| 4 | 5 | 6 |
| 7 | 8 | 9 |

ST MAURICE COUNTRY FAIR  
SITE PLAN

①

25 FT. SETBACK  
↓

FL

AMUSEMENT COMPANY RIDES

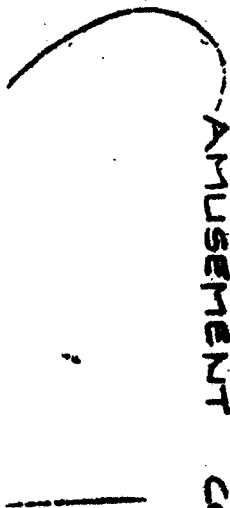

2

LAKE SHORE DRIVE

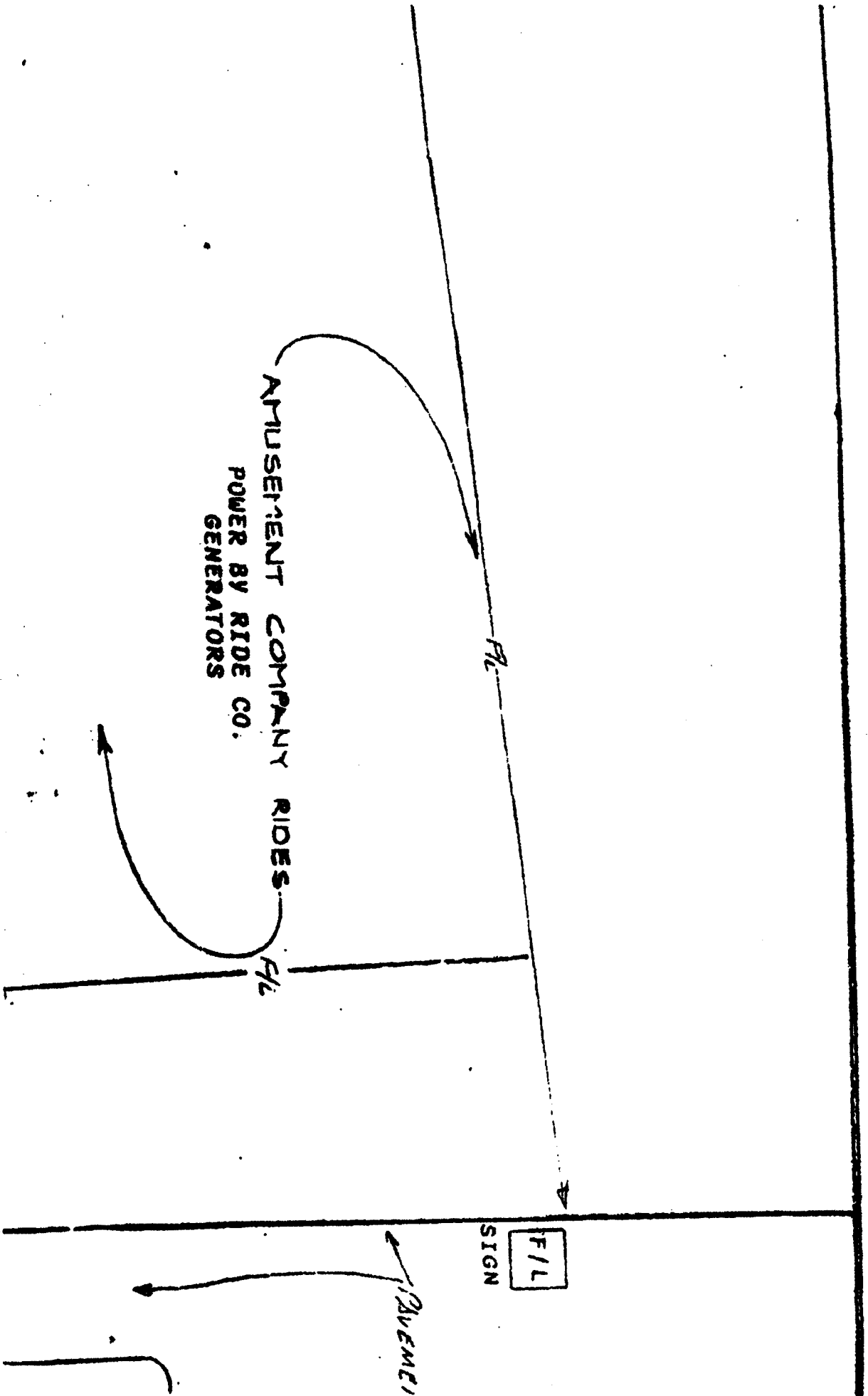

3

EXISTING PARKING AREA  
(500 SPACES)

8 PORTOILETS - GREG.  
2 HANDICAP

ROADWAY

F/L  
SIGN

F/L  
SIGN

# CE COUNTRY FAIR

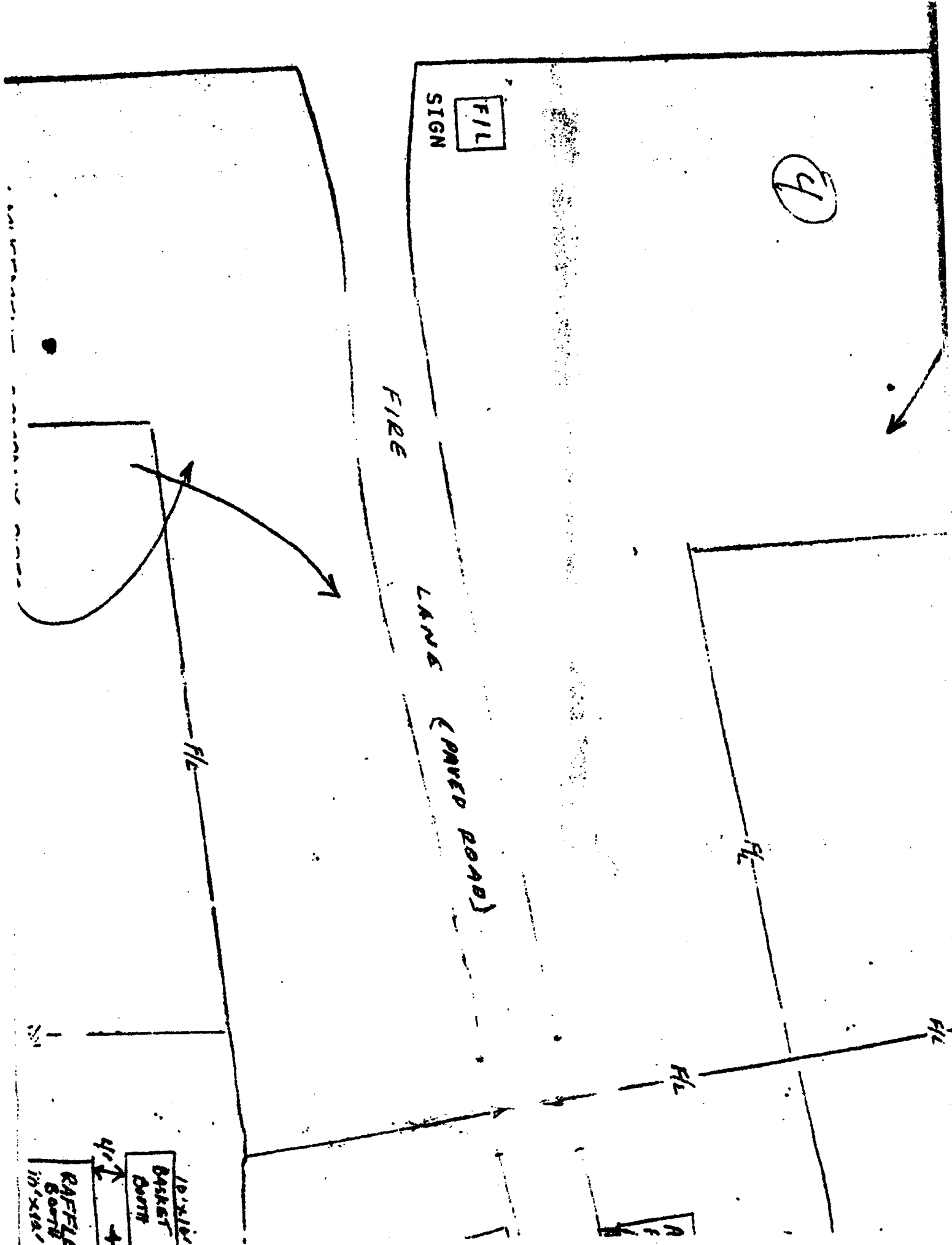





(12)

AMUSEMENT COMPANY RIDES

POWER BY GENERATORS (BY OTHERS)

\* ALL ELECTRICAL CORDS MUST BE SUFFICIENTLY PROTECTED FROM WATER & CAUSING A TRIP HAZARD. See 9/11/07

25 FT SETBACK

**I** SOURCE OF IGNITION, ALL SOURCES TO BE 10'-0" FIRE LANE- 20FT. MINIMUM WIDTH, NO OBSTRUCTION CLEARANCE MINIMUM 16'-0".

LEGEND AND NOTES:

**5** SINK #1 DISCHARGE TO HOADING TANK (FOOD) SINK #2 DISCHARGE TO CITY SEWER (WASTE)

10' x 16' Basket Drain  
4  
RAFFI 600TH 10' x 12'

F/L

F/L

F/L



Light Pole

8

BEER & CLEAN BOOTH  
16' X 30' [E]

BIG WHEEL  
10' X 10'

CASH FOR BOOTH  
10' X 15'  
ELECTRIC TABLE  
SAFETY PLANE  
660" 10' X 10'

(2) 400 gal Tanks

CAKE BOOTH  
10' X 10'

10' X 15'

400 AMP. 240 VOLT 1 PHASE  
SERVICE DISTRIBUTION BOARD  
ALL BOOTHS & LIGHTING DISTRIBUTION  
SUPPLIED FROM THIS

ELEC BLDG  
PIZZA BOOTH  
8' X 8'

(2) 400 gal Tanks  
FOOD  
8' X 10'

BINGO CANOPY  
20' X 40'

STORAGE SHED  
(Permanent)

SAFETY FENCE

FROM GAS.

NS, VERTICAL

6  
F/L

EIGHT (8) GAS TANK LOCATIONS WITH DURABLE PLASTIC NO SMOKING SIGNS TO BE POSTED AT ALL GAS CONTAINER LOCATIONS.  
(ALL ABOVE TANKS TO BE AIR AND VENT-CONTROLLED SYSTEMS SOURCE V. TRAD. DOWN)  
"FIRE LANE-NO PARKING-TWO-WAY ZONE" - SIGNS TO BE POSTED AS INDICATED ON PLAN. (DURABLE PLASTIC SIGN ON STAKES)

(14)  
(14)

2 GENERATORS, (1) 350 KW. & (1) 150 KW.

22 RIDG

REC

SI

